

YOUR NEXT EVENT SPACES

ABOUT TAI KWUN

Tai Kwun is Hong Kong's cultural destination for inspiration, stimulation and enjoyment. We aspire to offer the best heritage and arts experiences, and to cultivate knowledge and appreciation of contemporary art, performing arts and history in the community.

Tai Kwun invites all visitors on a journey of discovery that unites multiple genres of arts, heritage, culture and lifestyle in Hong Kong. Here, visitors will discover the rich heritage of the site through the thematic exhibitions and immersive public programmes that explore Hong Kong's history and culture, alongside a multitude of vibrant and inclusive contemporary art presentations and performing arts offerings all year round.



TAI KWUN

— YOUR VENUE of CHOICE

Located in the heart of Central, Hong Kong Island, Tai Kwun, neighbouring with other important heritage sites in Central and Sheung Wan, is conveniently connected to Hollywood Road, Lan Kwai Fong and Soho. With a bustling community surrounded by galleries, antique shops, restaurants and bars, Tai Kwun's neighbourhood breathes the essence of a vibrant cultural life.

Tai Kwun is easily accessible via public entrance gates. Visitors can also enter via a footbridge at the intersection of Hollywood Road and Old Bailey Street, which connects the compound with the Central to Mid-Levels Escalator.

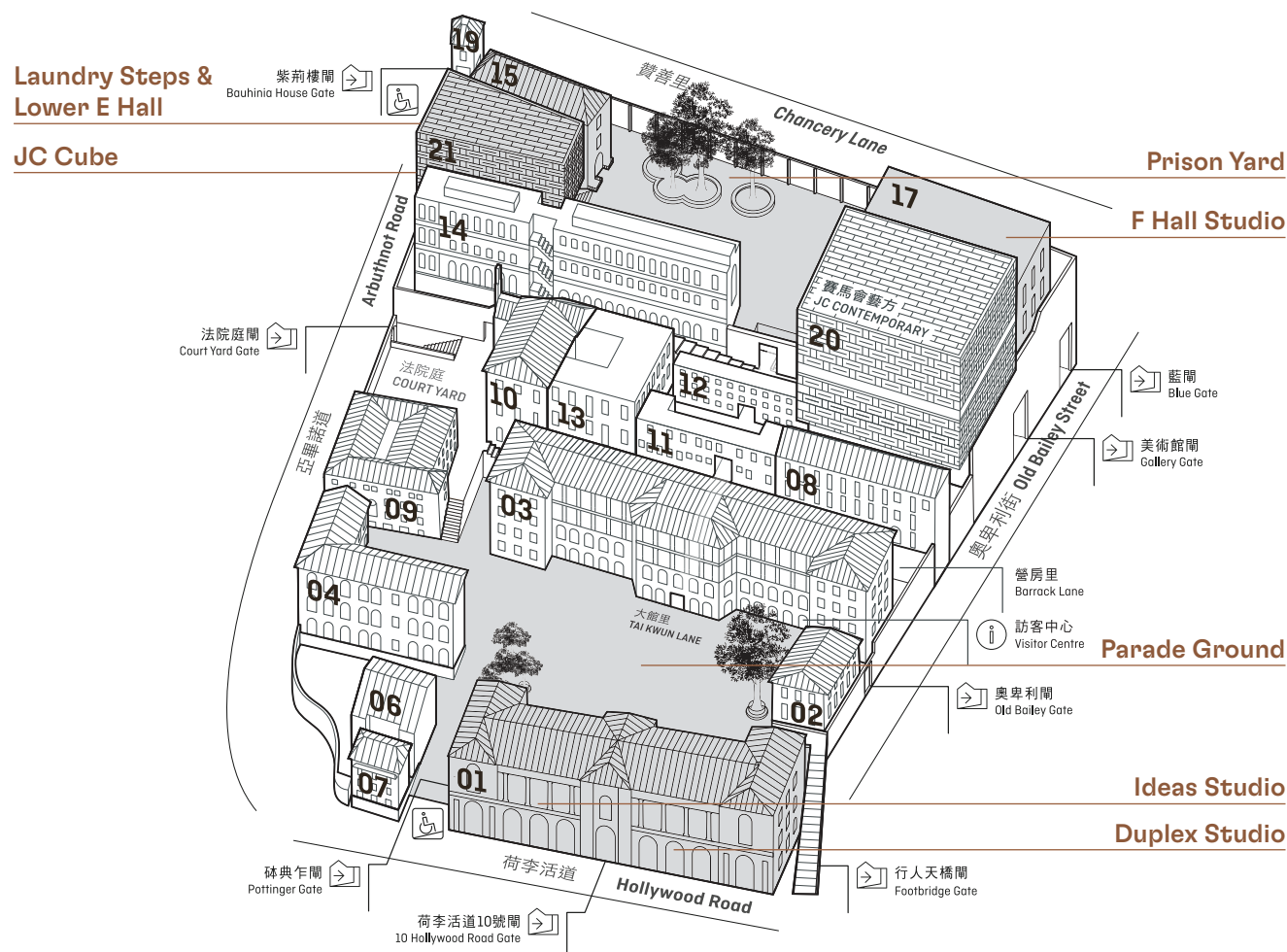

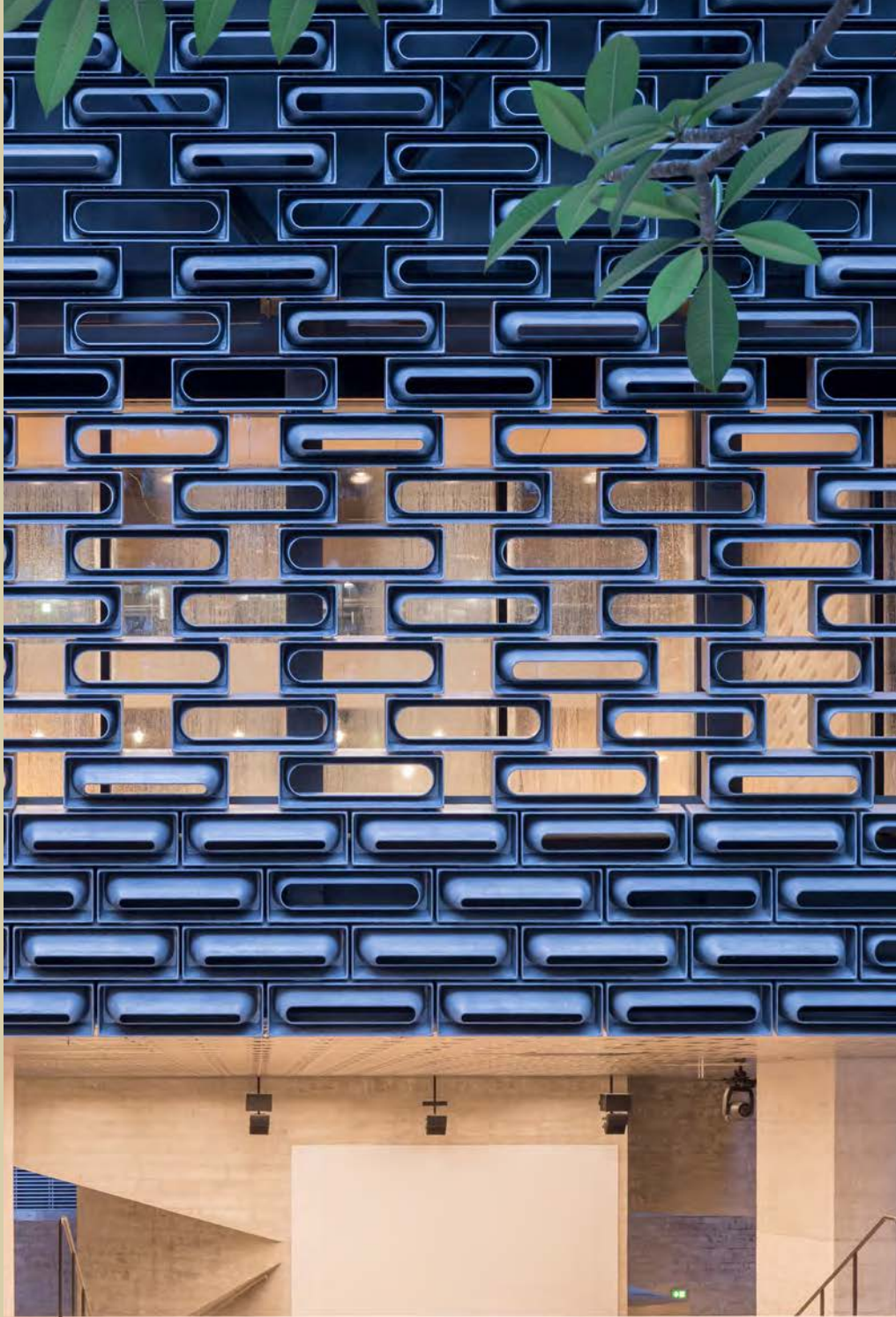

JC CUBE

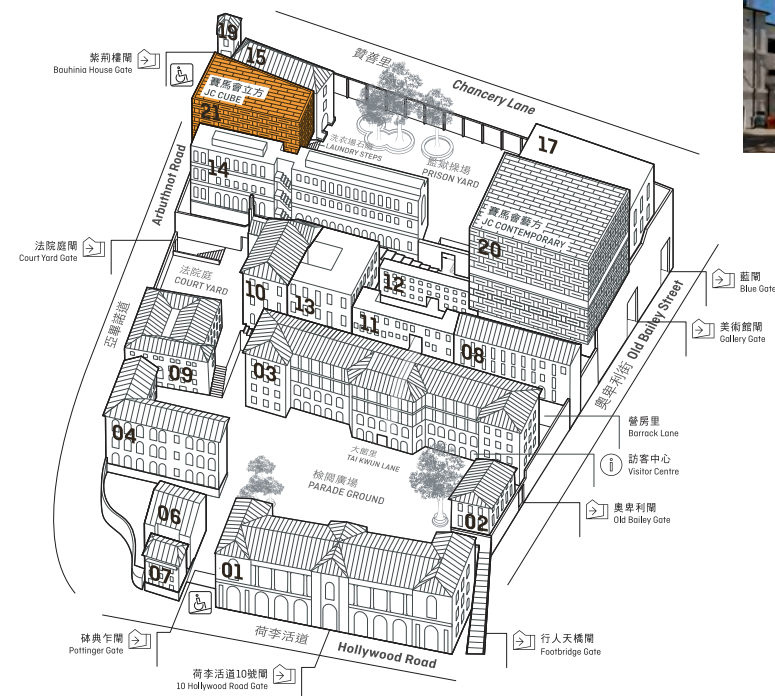
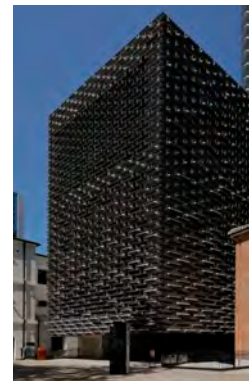

Floor Plan

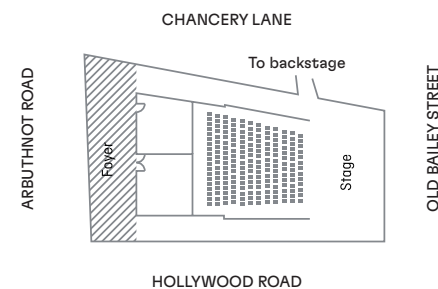

Auditorium Stage Size

~10m (W) x 4m (D)

Capacity

192 Seats

Headroom

~8m

Foyer Area

1,100 sq. ft.

Scan or click
for Virtual tour



JC CUBE

- **VERSATILE** venue ideal for conferences, performances, screenings, and media events
- **FULLY-EQUIPPED** auditorium with a 35mm & 4K digital cinema projector
- **WORLD-RENOWNED** architecture designed by the Herzog & de Meuron team
- **NATURAL** sunlight creates a surreal atmosphere and connects the modern building with the historic prison yard
- **WELCOMING** foyer perfect for cocktail hours, light refreshments, and lively conversation



© Kwai Fung Salone

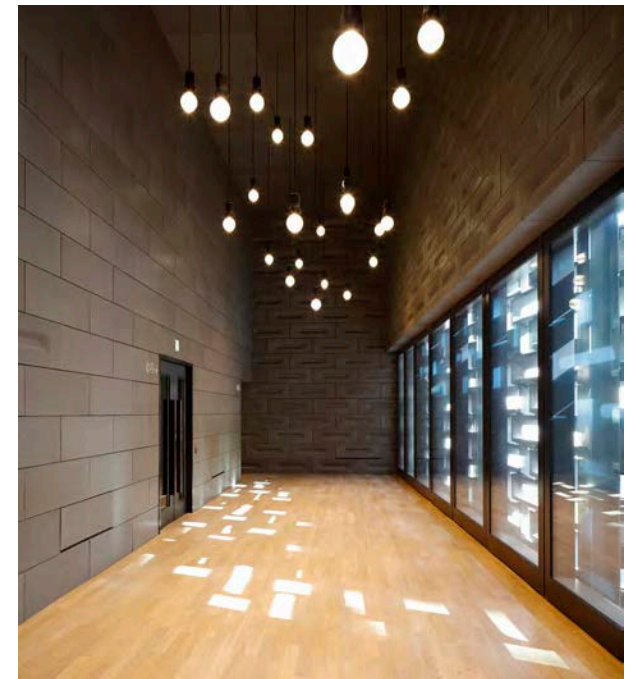



DUPLEX STUDIO

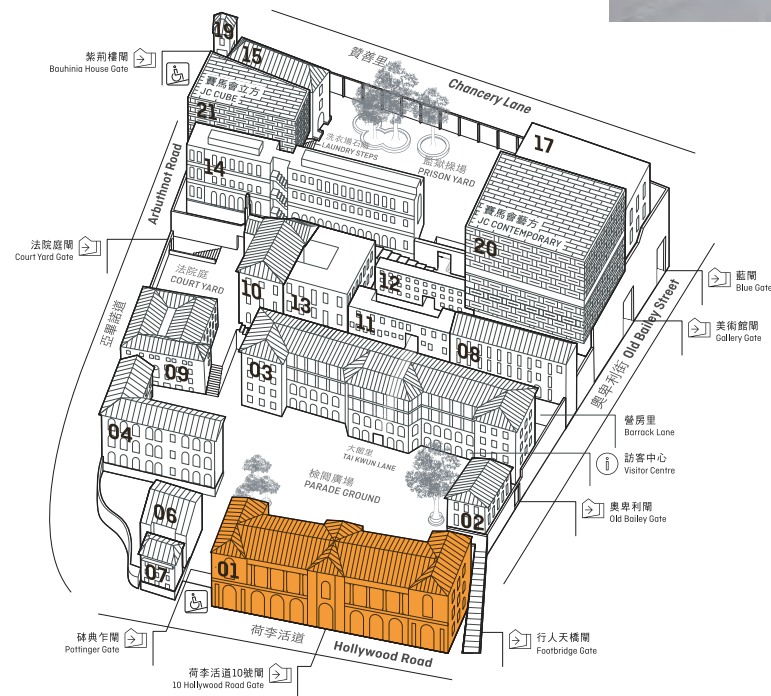

Floor Plan

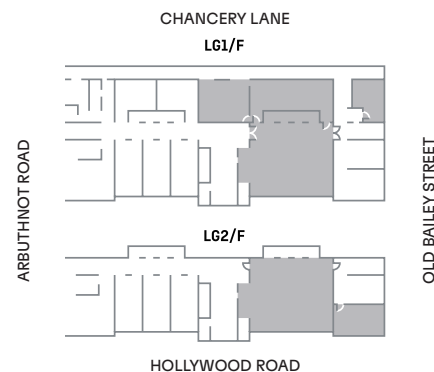

Area

~6,300 sq.ft.

Capacity

~140

Headroom

LG2/F ~ 7m

LG1/F ~ 3m

Scan or click
for Virtual tour



DUPLEX STUDIO

- **SPACIOUS** indoor venue, two-story tall and drenched in natural daylight
- **HISTORIC** architectural design features
- **MAGNIFICENT** space for large-scale exhibitions, corporate branding events, cocktail parties, or private functions



© Audemans Piguet (Hong Kong) Ltd





F HALL STUDIO

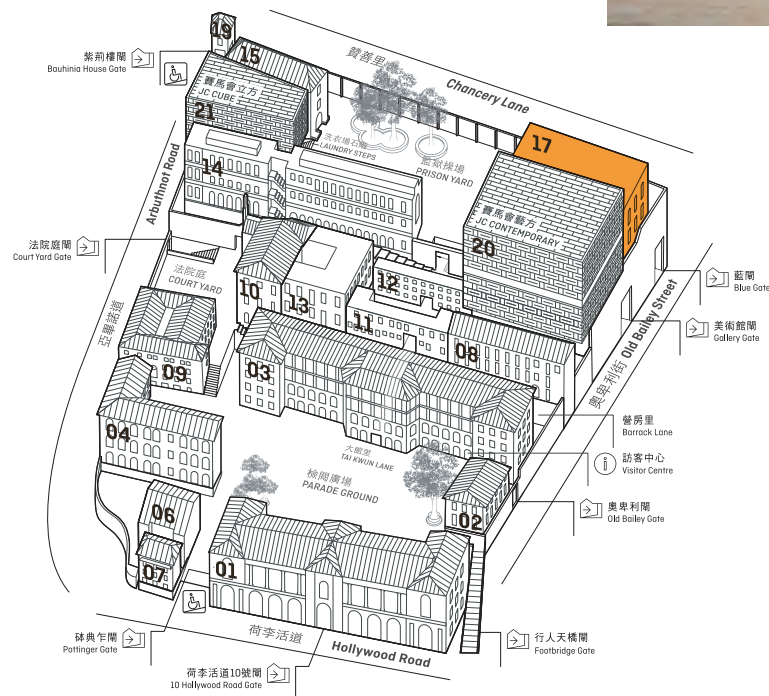

Floor Plan

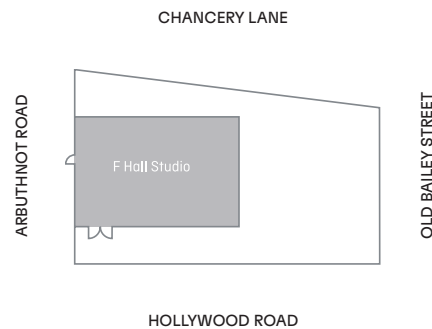

Area

~2,100 sq.ft.

Capacity

92

Headroom

~4m

Scan or click
for Virtual tour



F HALL STUDIO

- **UNIQUE** white cube exhibition space that supports diverse and flexible installations
- **TRANSFORMATIVE** moods created by projection & audio available on request
- **ADAPTABLE** space suitable for immersive presentations, workshops, product launches, and talks



© Jebsen Consumer Products Company Limited



© Swarovski Hong Kong Ltd

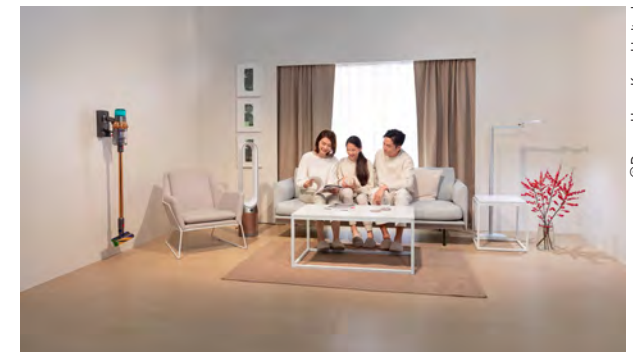

© Dyson Hong Kong Limited



LAUNDRY STEPS

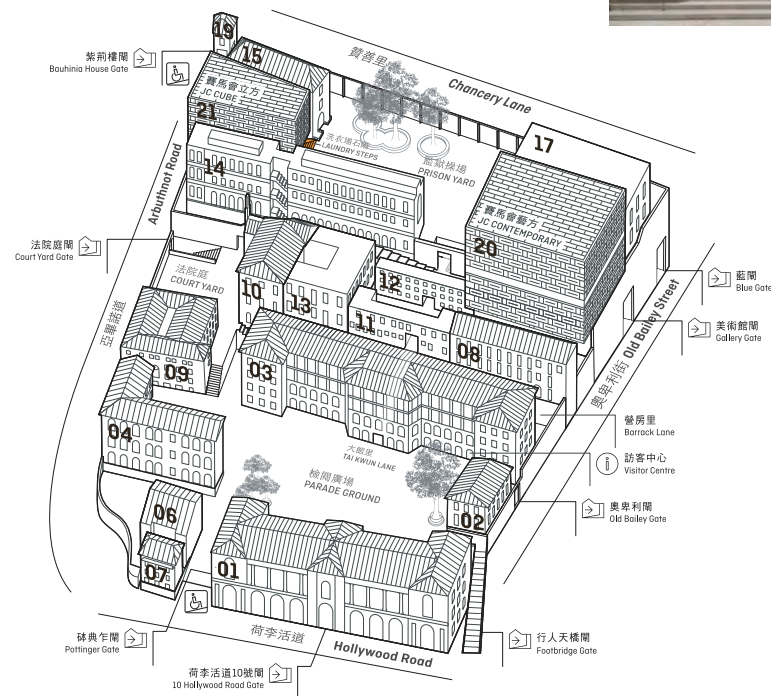

Floor Plan

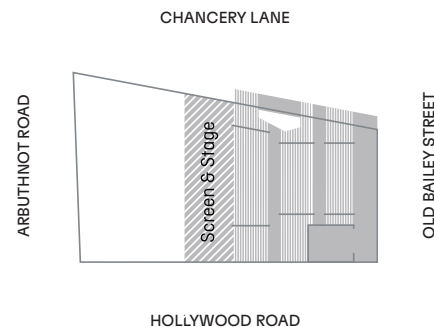

Stage Size

~14m x 5m

Area

~2,100 sq.ft.

Capacity

120 Seats

Headroom

~7m

Scan or click
for Virtual tour



LAUNDRY STEPS

- **SEMI-OPEN** event space fosters creative thinking and connection
- **PRACTICAL** for presentation with projection and audio apparatus
- **FLEXIBLE** staging space that can be extended to include the adjacent Lower E Hall
- **ICONIC** Tai Kwun chairs that were awarded the Hong Kong Smart Design Awards 2023 Gold Award





LOWER E HALL

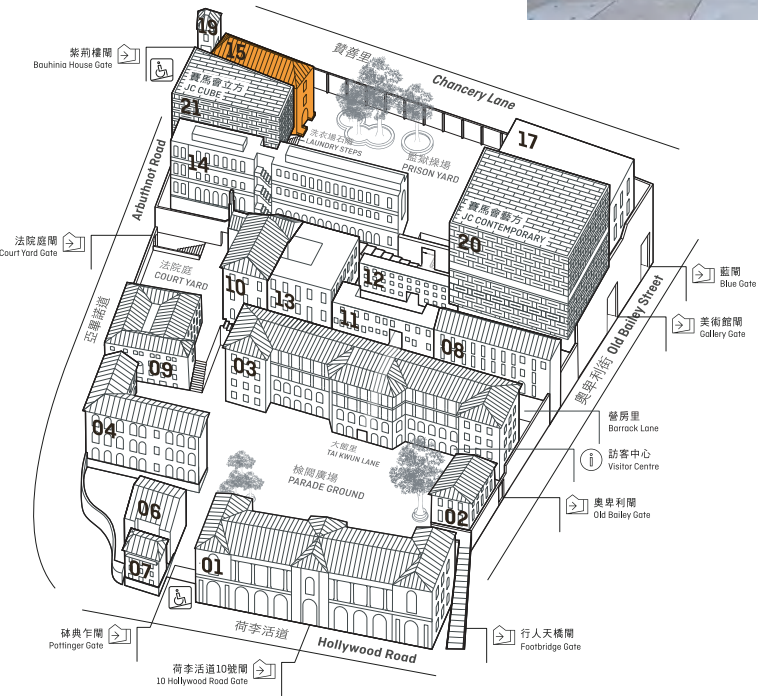

Floor Plan

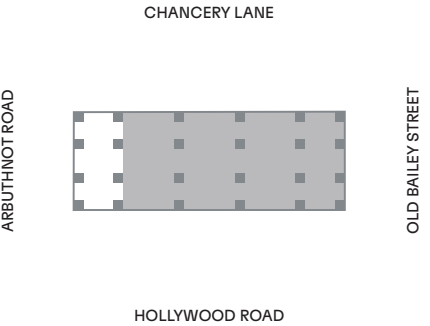

Area
~2,300 sq.ft.

Capacity
76

Headroom
~2m

Scan or click
for Virtual tour



LOWER E HALL

- **INTIMATE** semi-open oasis for distinctive exhibitions, energetic cocktail hours, insightful workshop sessions, or private networking and showcase events
- **DELIGHTFUL** vibes among the Tai Kwun's secret garden
- **ADJUSTABLE** venue that can be extended to include the adjacent Laundry Steps



© Pernod Ricard Asia Duty Free Limited



© Pernod Ricard Asia Duty Free Limited



© Xu Liang Leon



PARADE GROUND

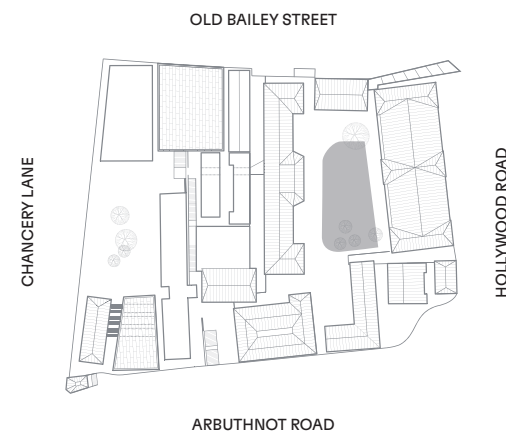
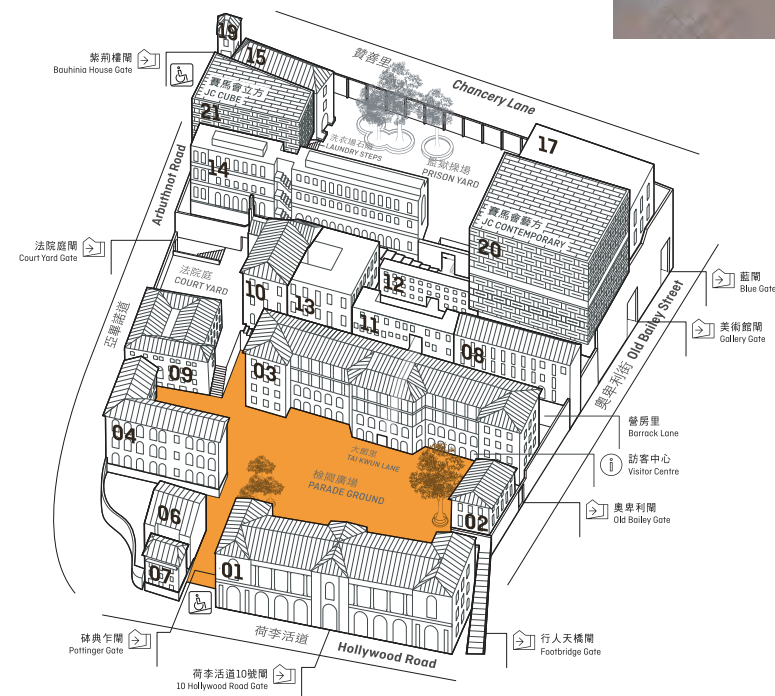

Area
~12,000 sq.ft.

Capacity
~300

Scan or click
for Virtual tour



PARADE GROUND

- **SIGNATURE** spot at the heart of Tai Kwun's historic compound
- **AESTHETIC** sensibilities unite with pragmatic utility seamlessly
- **SPIRITED** arena for exhibitions, performances, product launches, and engaging experiences





PRISON YARD

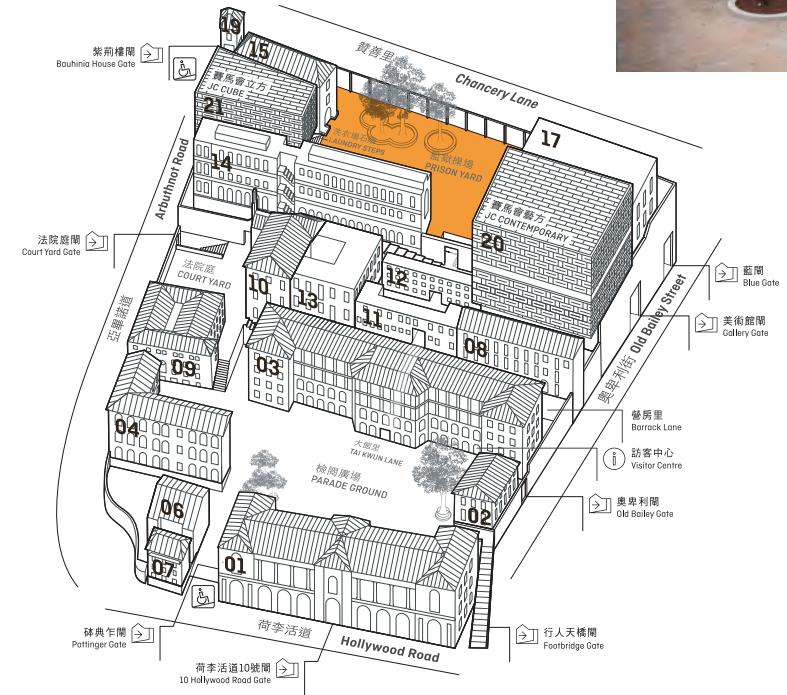

Area
~14,000 sq.ft.

Capacity
~300

Scan or click
for Virtual tour



PRISON YARD

- **HARMONICALLY** nestled between Central's modern high-rises and Tai Kwun's historic buildings
- **TRANQUIL** square suited for exhibitions, ceremonies, performances, and corporate retreats
- **ACCESSIBLE** space providing a well-rounded environment for medium to large-sized events





IDEAS STUDIO

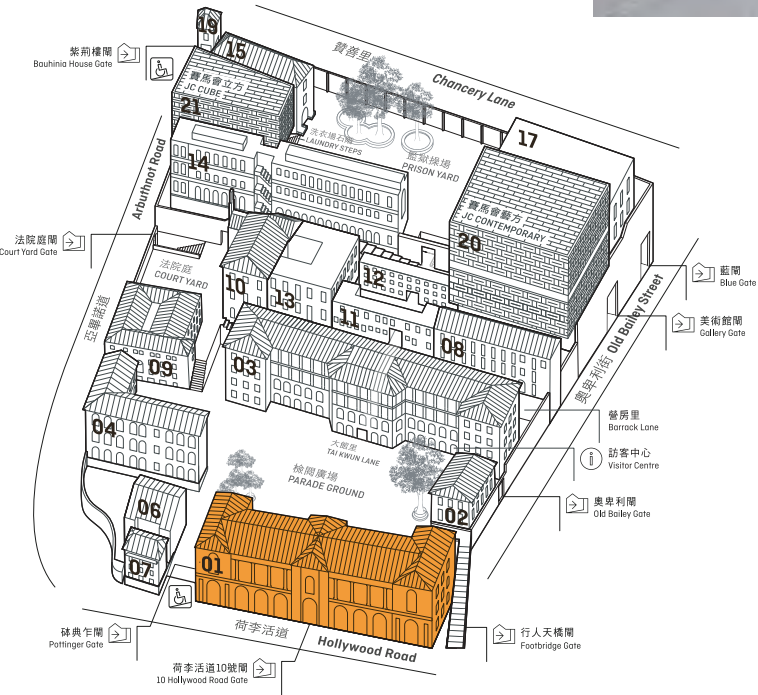

Floor Plan

Area

~750 sq.ft.

Capacity

24

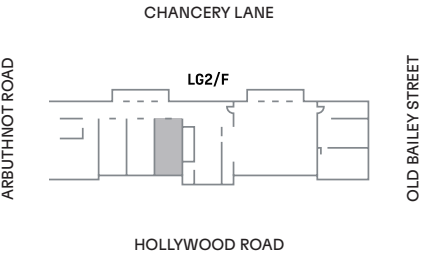

IDEAS STUDIO

- **REFURBISHED** space designed for private meetings, training programmes and small-scale workshops
- **HANDY** set up with digital TV and presentation system
- **CONVERTIBLE** seat settings to accommodate different functions

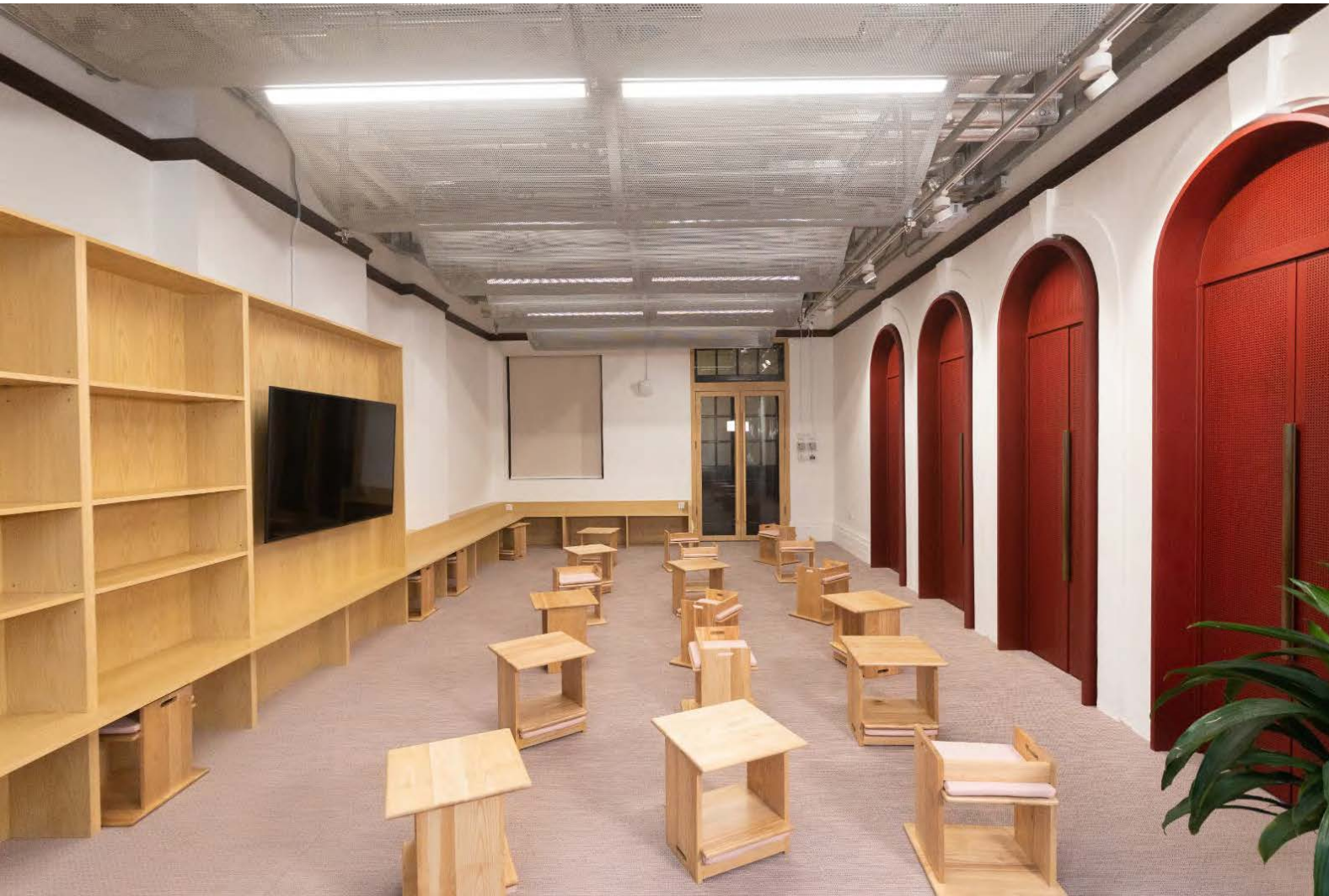

VALUE ADDED SERVICE

Food & Beverage Support

Dining outlets network at Tai Kwun

Catering & Cocktail Services

Manpower

Technicians

Ushers

Cleaners

Guards

FAQ

How to apply?

Please fill in the online enquiry form. Applications will be assessed based on a list of criteria, including but not limited to strategic fit with Tai Kwun's vision, brand strategy for public programmes, as well as community and revenue considerations. An event proposal would assist the assessment process.

How many days in advance to book?

The venue is available on a first-come first served basis. Typically, it takes at least 8 weeks in advance to process the booking.

Is food & beverage allowed in the function space?

Eating and drinking are prohibited in the auditorium of JC Cube. For other venues, Tai Kwun tenants are the preferred choice for catering services. Corresponding food licenses may apply to other catering service providers.

Is Wi-Fi available?

Public Wi-Fi is available in the compound for free, with a limited speed of 3 hours per day per device. To ensure a more stable internet connection during events, it is suggested to hire additional LAN service with exclusive bandwidth.

What is the earliest possible time for us to begin setup, and what is the latest time by which we must complete dismantling and move out?

Please note that the hiring period shall include both setup and dismantling time. The standard hiring period is from 08:00 to 23:00.

Can we drive to Tai Kwun?

Please note that there is no parking lot in the compound, please consider using the nearby car parks on the following location map, parking is at the guest's own risk.

FOOD & BEVERAGE

BARS

GISHIKI LOUNGE



Police Headquarters
Block, Block 01
LG1/F | 01-LG103
☎ 2884 0114

THE DISPENSARY



Police Headquarters
Block, Block 01
1/F | 01-1/F
☎ 2848 3000

ARMOURY TERRACE



Armoury, Block 02
G/F | 02-G/F
☎ 9738 4979

BOTANICAL GARDEN



Central Magistracy,
Block 09
G/F | 09-G/F
☎ 2252 3177

DRAGONFLY



Superintendent's
House & C Hall,
Block 10 & 13
G/F | 10 & 13-G01 & G03
☎ 9359 0999

001



10 & 13 Superintendent's
House & C Hall
1/F | 10 & 13-101
☎ 2810 6969

WESTERN CUISINE

法國巴黎小館 CAFE CLAUDEL



Police Headquarters
Block, Block 01
G/F | 01-G08
☎ 2411 1310

CANTINA



Police Headquarters
Block, Block 01
1/F | 01-1/F
☎ 2848 3000

PAZTA



Barrack Block, Block 03
G/F | 03-G08
☎ 2626 1186

MAGISTRACY DINING ROOM



Central Magistracy,
Block 09
G/F | 09-G/F
☎ 2252 3177

ASIAN CUISINE

SUSHI ZO



Police Headquarters
Block, Block 01
LG1/F | 01-LG103
☎ 2884 0114

樂茶軒茶藝館 LOCKCHA TEA HOUSE



Police Headquarters
Block, Block 01
G/F | 01-G07
☎ 2276 5777

THE CHINESE LIBRARY



Police Headquarters
Block, Block 01
1/F | 01-1/F
☎ 2848 3088

AAHARN



Armoury, Block 02
1/F | 02-1/F
☎ 2703 9111

MADAME FÙ - GRAND CAFÉ CHINOIS



Barrack Block, Block 03
3/F | 03-3/F
☎ 2114 2118

ON THE HILL COFFEE BAR



E Hall, Block 15
G/F | 15-G/F
☎ 9841 4827

BETWEEN



JC Contemporary,
Block 20
2/F | 20-2/F
☎ 2877 8711

SCAN AND CLICK FOR
MORE INFORMATION



LOCATION & TRANSPORTATION

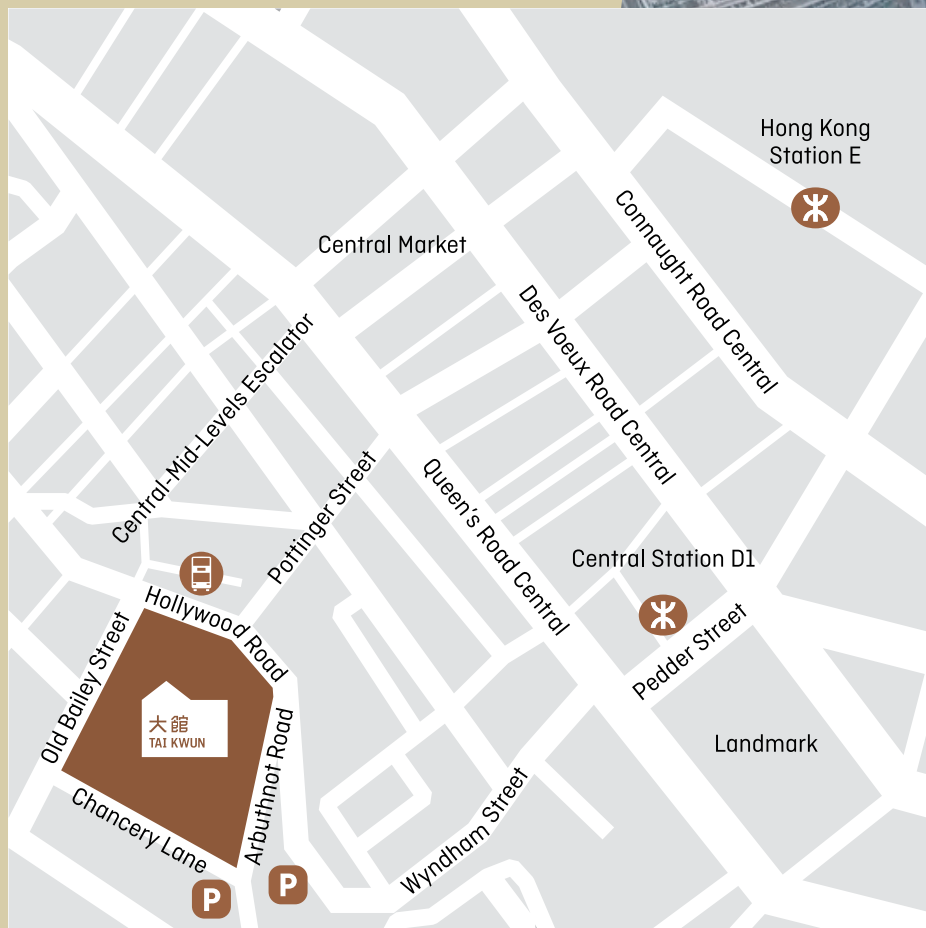

RECOMMENDED TRANSPORTATIONS TO TAI KWUN

MTR

Central Station Exit D1 – Wheelock House

Walk towards Sheung Wan along Queen's Road Central and turn left at the junction with Queen Victoria Street, to reach Tai Kwun via escalator in 100QRC and the Central to Mid-Levels Escalator.

Hong Kong Station Exit E – One International Finance Centre (One IFC)

Walk through the Central Elevated Walkway (footbridge) to the former Central Market, and reach Tai Kwun directly via the Central to Mid-Levels Escalator and Walkway System



Bus (Via Hollywood Road)

Citybus routes 12, 12M & 40M

New World First Bus routes 13 & 26

Cross Harbour Bus route H1 (to Tsim Sha Tsui only)



Parking

Car parking is not available inside Tai Kwun. If you are driving, you can use the hourly car parks nearby, including:

Universal Trade Centre Car Park (3 Arbutnot Road)

The Centrium Car Park (2 Arbutnot Road)

This document is for information purposes only. The information is provided without warranty of any kind, either express or implied, and is subject to change without prior notice. Approvals from The Jockey Club CPS Limited and/or third parties are required for the use or distribution or exploitation of the contents and/or information herein. Any hiring of event space is subject to the "Terms and Conditions of Hire".

© Tai Kwun 2023 Tai Kwun is the trading name of The Jockey Club CPS Limited



CONTACT

Please scan or click and fill in the enquiry form, our team will be in touch with you shortly.

www.taikwun.hk