

大館
TAI KWUN

古蹟及藝術館
CENTRE FOR HERITAGE & ARTS

YOUR NEXT EVENT SPACES

保育活化 Conserved and revitalised by



香港賽馬會
The Hong Kong Jockey Club

ABOUT TAI KWUN

Opened in May 2018, Tai Kwun — Centre for Heritage and Arts is the fruition of a joint partnership between The Hong Kong Jockey Club and the Government of the HKSAR to conserve and revitalise the buildings of the Central Police Station (CPS) compound. The site is managed and operated by The Jockey Club CPS Limited.

The CPS compound comprises three declared monuments (the former Central Police Station, Central Magistracy and Victoria Prison), with a total of 16 heritage buildings and some outdoors spaces, on a 13,600 square-metre site in the heart of Central. An international-grade non-commercial art gallery and an auditorium have been added to contribute to the adaptive reuse of the site.

Tai Kwun is the colloquial name used by police officers and the public alike to refer to the former police headquarters and the surrounding CPS compound. The name has been adopted by The Jockey Club CPS Limited as a reminder of the historical importance of the site.

In 2019, Tai Kwun received the Award of Excellence in the UNESCO Asia-Pacific Awards for Cultural Heritage Conservation in recognition of its achievement in conservation and revitalisation. This is the Awards' highest honour.



獲頒2019年度聯合國教科文組織
亞太地區文化遺產保護獎——卓越項目獎
Recognized with 2019 UNESCO Award of Excellence

TAI KWUN — YOUR VENUE OF CHOICE

Conservation — Steeped in history, Tai Kwun is a compound of invaluable and priceless heritage buildings that now point to the future. An integral part of the community, Tai Kwun's 16 historic buildings bear witness to the story of Hong Kong's successful journey.

Connection — An iconic haven of serenity within our energetic and fast-paced cosmopolitan city, Tai Kwun transcends its role as a leisure destination for visitors in search of cultural immersion to become a centre of ideas generation with the power to inspire fresh business perspectives.

Convergence — Easily accessible and conveniently located at the heart of Asia's business and financial hub, Tai Kwun brings together diverse industries while connecting people from all walks of life.

Creativity — The perfect stage to host vibrant commercial activities — from conferences, seminars, press conferences and product launches to cocktail parties, workshops and business retreats — Tai Kwun is the ideal platform for any events your creative minds may conjure.

Continuity — A story-telling platform embedded with treasures of knowledge, Tai Kwun is the perfect site to hold professional development programmes in a holistic, sophisticated atmosphere where culture and history blend with unique retail experiences and inspiring culinary options.

EVENT SPACES FOR HIRE

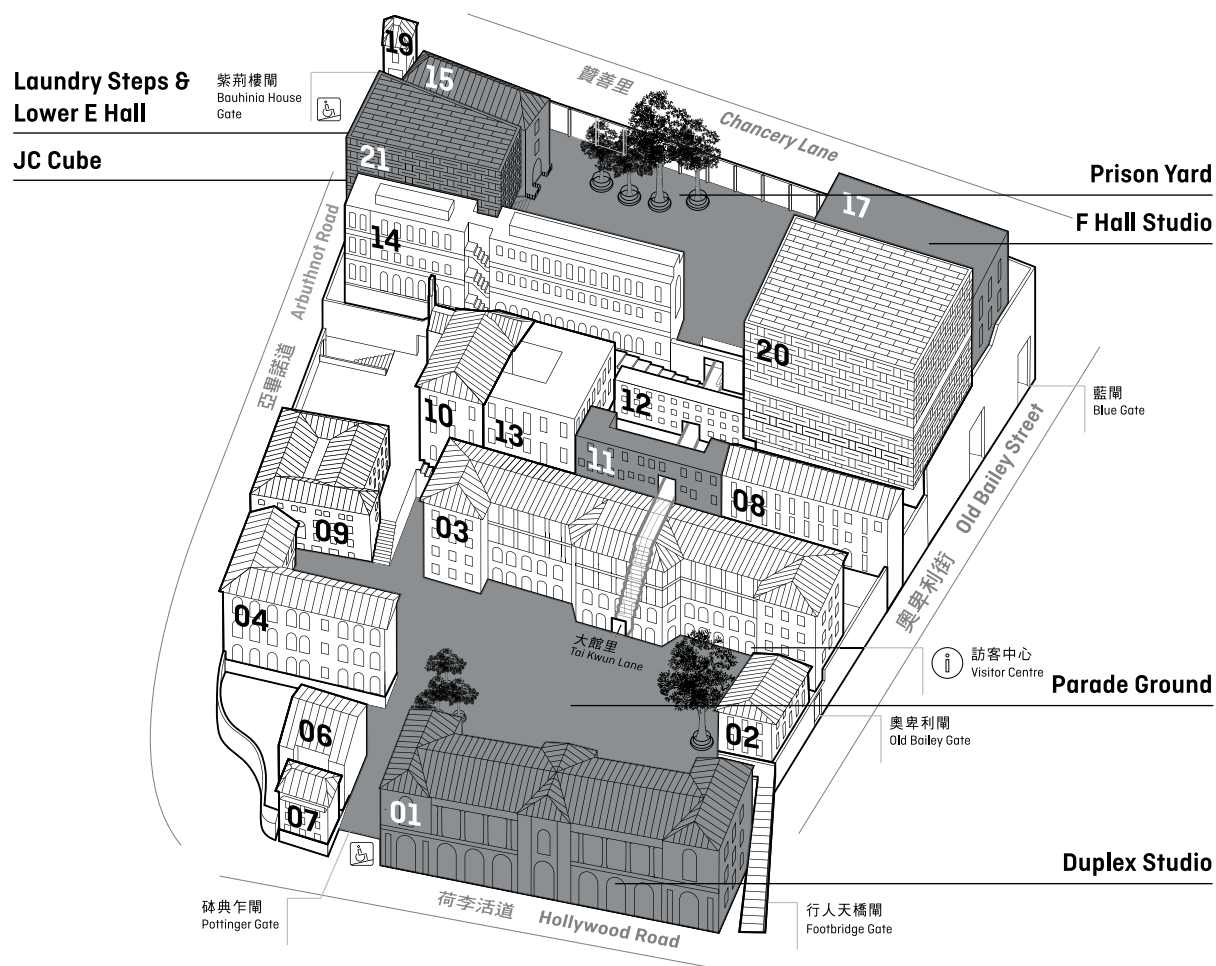



JC CUBE

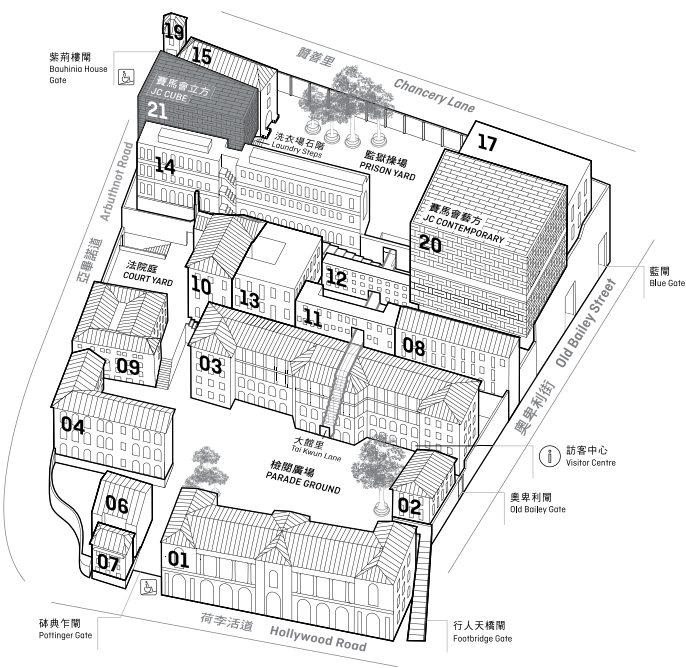

FLOOR PLAN

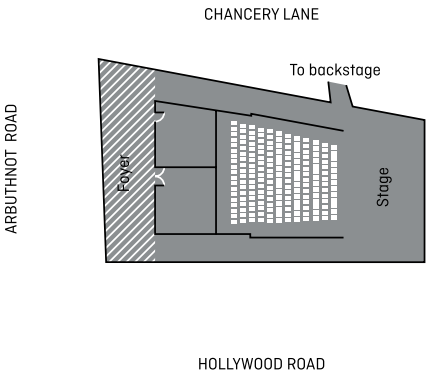

SPECIFICATION

- Foyer Area: ~1,100 sq.ft.
- Capacity: 205 Seats
- Stage size: ~10m (W) x 4m (D)
- Headroom: ~8m

JC CUBE



Foyer



HIGHLIGHTS

- Suitable for Ceremonies, Media Events, Conferences, Screenings & Performances
- Designed by internationally renowned architectural practice Herzog & de Meuron
- Professional stage facilities equipped with stage lights & loudspeakers system
- Theatre setting with Dolby Digital 7.1 Surround Sound and 35mm & 4K Digital Cinema Projector for screenings

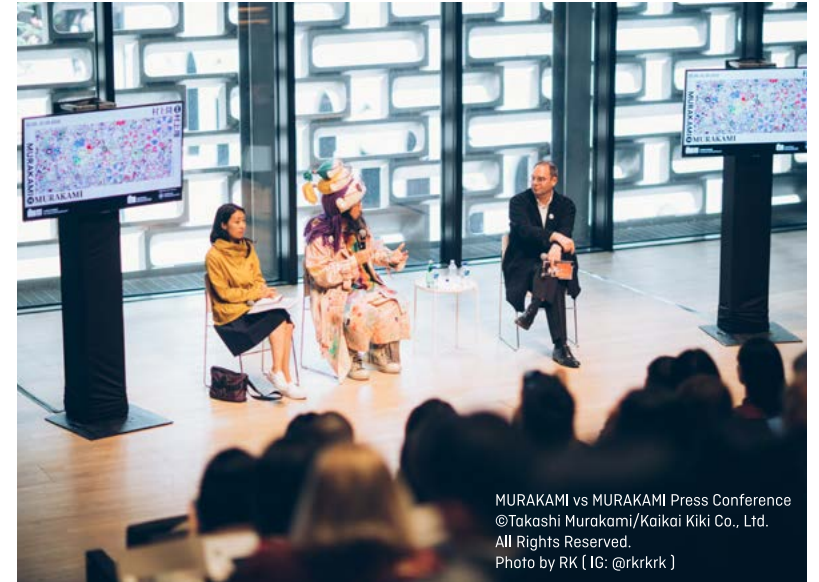

MURAKAMI vs MURAKAMI Press Conference
©Takashi Murakami/Kaikai Kiki Co., Ltd.
All Rights Reserved.
Photo by RK [IG: @rkrkrk]





LAUNDRY STEPS + LOWER E HALL

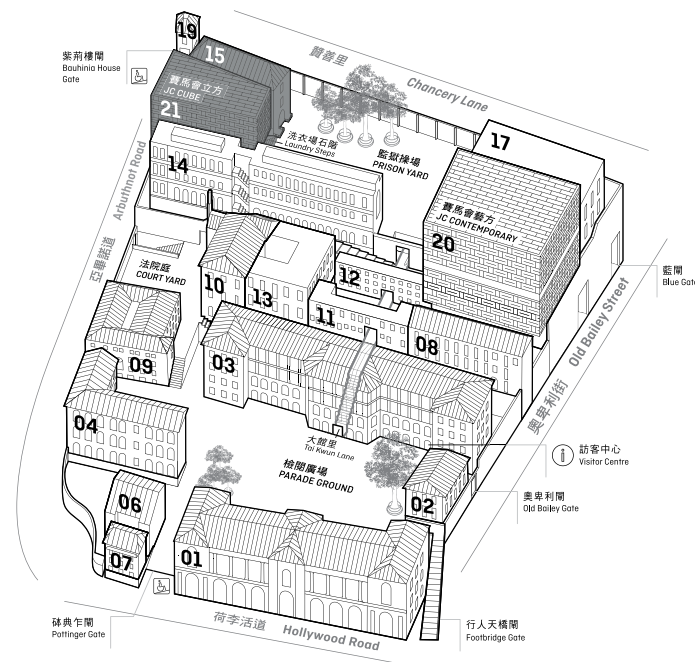

LAUNDRY STEPS HIGHLIGHTS

- Suitable for Ceremonies, Talks, Screenings & Performances
- Flexible venue and usage that can be extended to include the adjacent Lower E Hall
- Semi-open and perfect to host free-seating casual events

LOWER E HALL HIGHLIGHTS

- Suitable for Exhibitions, Cocktails & Workshops
- Inspiring colonial design features
- Flexible venue and usage that can be extended to include the adjacent Laundry Steps

LAUNDRY STEPS + LOWER E HALL

FLOOR PLAN

LAUNDRY STEPS

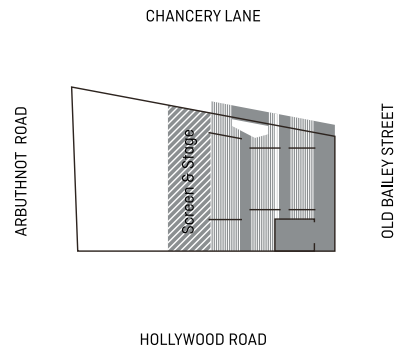

SPECIFICATION

Area: ~2,100 sq.ft.

Capacity: 250

Stage size: ~14m x 5m

Headroom: ~7m



FLOOR PLAN

LOWER E HALL

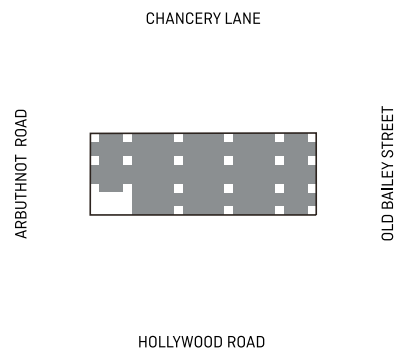

SPECIFICATION

Area: ~2,300 sq.ft.

Capacity: 76

Headroom: ~2m





PARADE GROUND

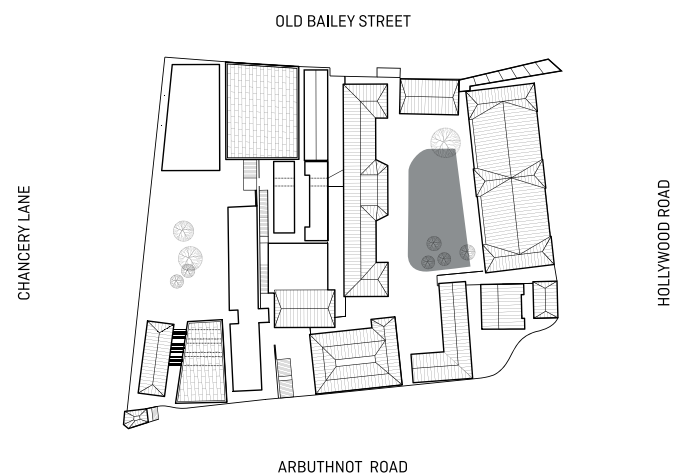
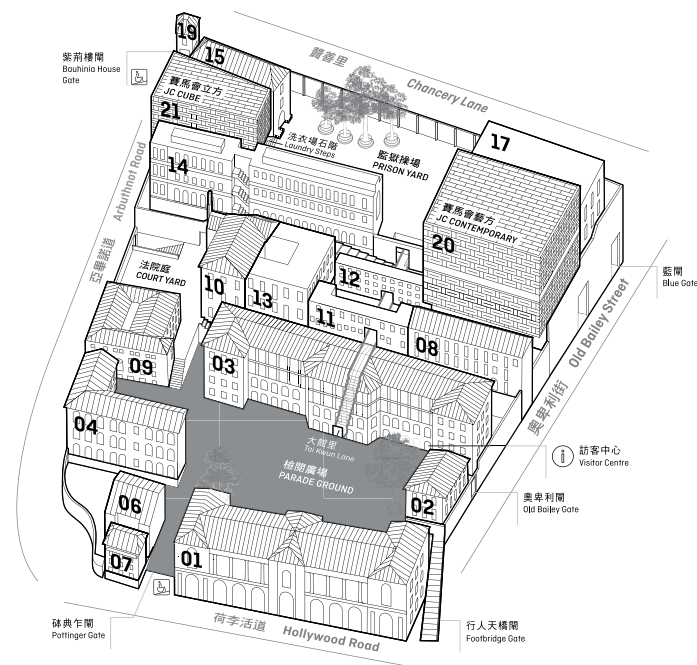

SPECIFICATION

Area: ~12,000 sq.ft.

Capacity: 600

PARADE GROUND



HIGHLIGHTS

- Set amidst F&B outlets and commercial activities, it's suitable for Exhibitions, Performances, Product Launches & any dynamic, creative and fun activities
- Central location within the site's highest traffic open space to draw public attention



Cartier Christmas at Tai Kwun



OMEGA Golden Astronaut display for celebrating 50th Anniversary of Moonlanding with OMEGA Speedmaster





PRISON YARD

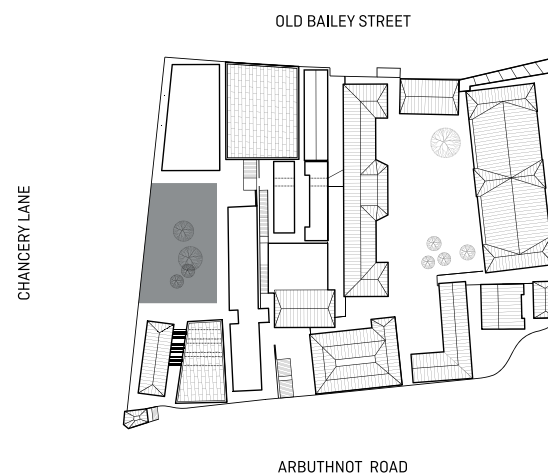
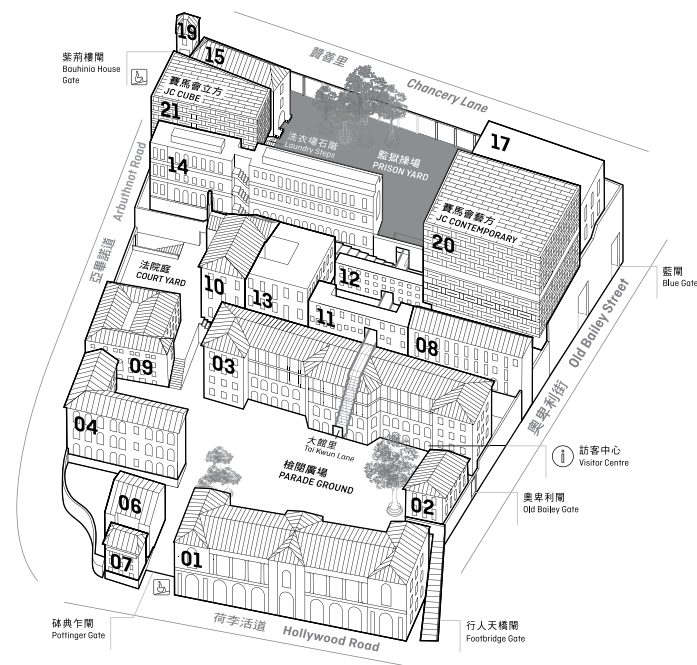

SPECIFICATION

Area: ~14,000 sq.ft.

Capacity: 600

PRISON YARD



HIGHLIGHTS

- Suitable for Exhibition, Commercial functions, Cocktails, Ceremonies & Performances
- Open space sets against the backdrop of the Prison Wall
- Cozy atmosphere ideal for relaxed and casual events



Family Workshop



Performance photo of Pelot Performer: Joan Catala



DUPLEX STUDIO

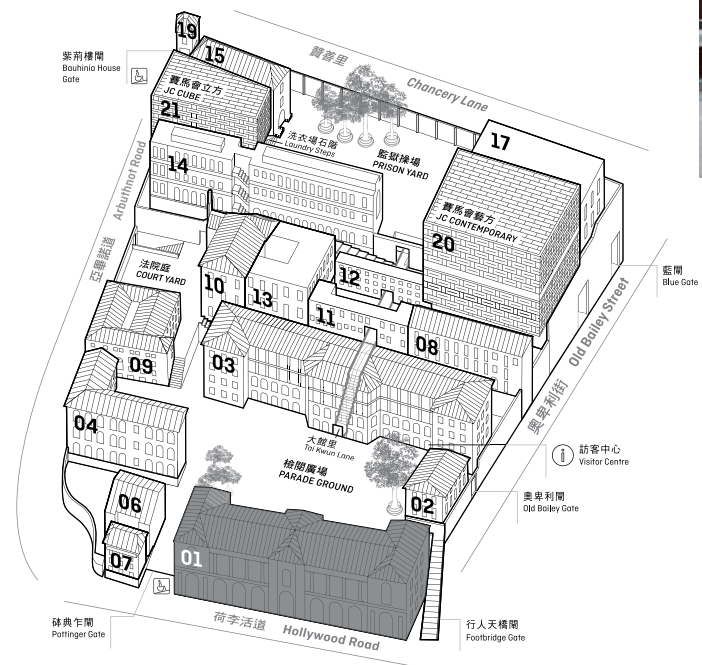

FLOOR PLAN

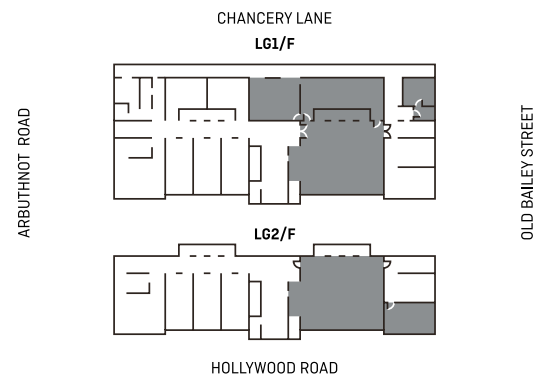

SPECIFICATION

Area: ~6,300 sq.ft.

Capacity: 140

Headroom: ~7m

DUPLEX STUDIO



HIGHLIGHTS

- Suitable for Exhibitions, Product Launches, Cocktails & Private Functions
- Tai Kwun's largest indoor venue for hire, featuring a rectangular floor plan and double-height ceiling
- Four separate break-out rooms

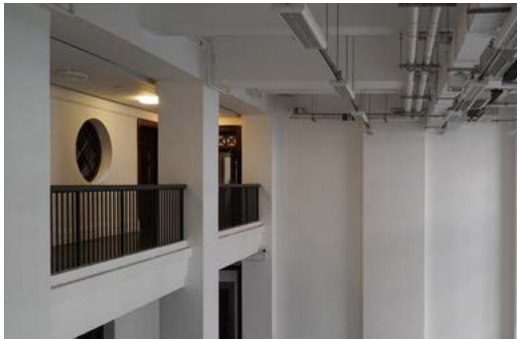

Installation view of "100 Faces of Tai Kwun"



Installation view of "Tai Kwun 101"



F HALL STUDIO

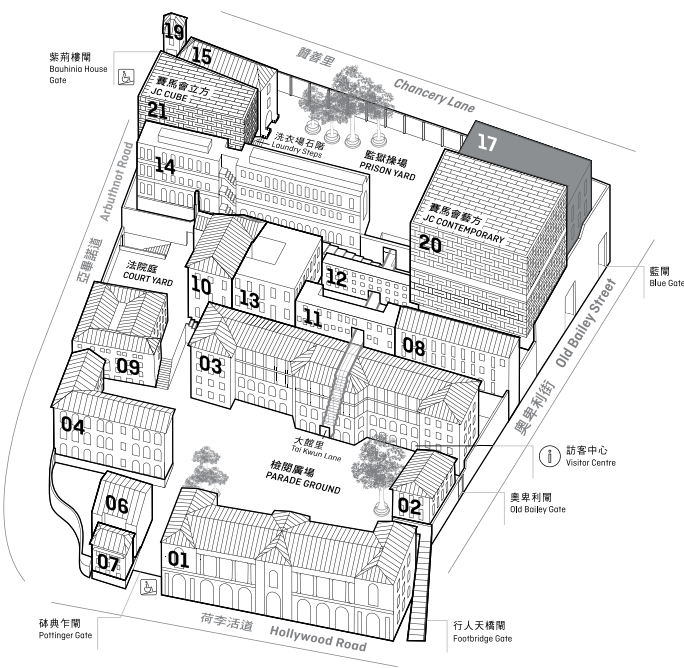

FLOOR PLAN

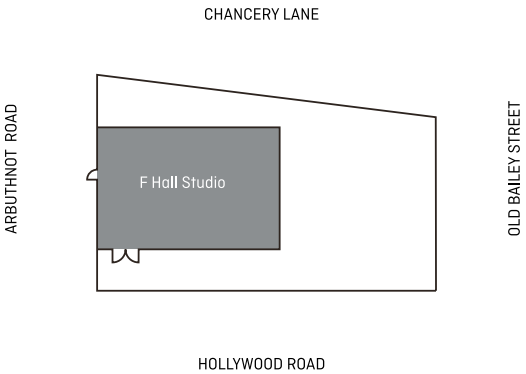

SPECIFICATION

Area: ~2,100 sq.ft.
Capacity: 92
Headroom: ~4m

F HALL STUDIO

HIGHLIGHTS

- Suitable for Exhibitions, Talks & Commercial Functions
- Basic design supports diverse and flexible settings



VALUE-ADDED SERVICES

Food & Beverage Support

- Dining outlets network at Tai Kwun
- Catering & Cocktail Services

Guided Tours and Experience

- Heritage Tours
- Curator-led Exhibition Guided Tours
- Corporate Guided Tours
- Family Day Workshops
- Kids' Workshops

Others

- Professional Technical Support



LOCATION & TRANSPORTATION

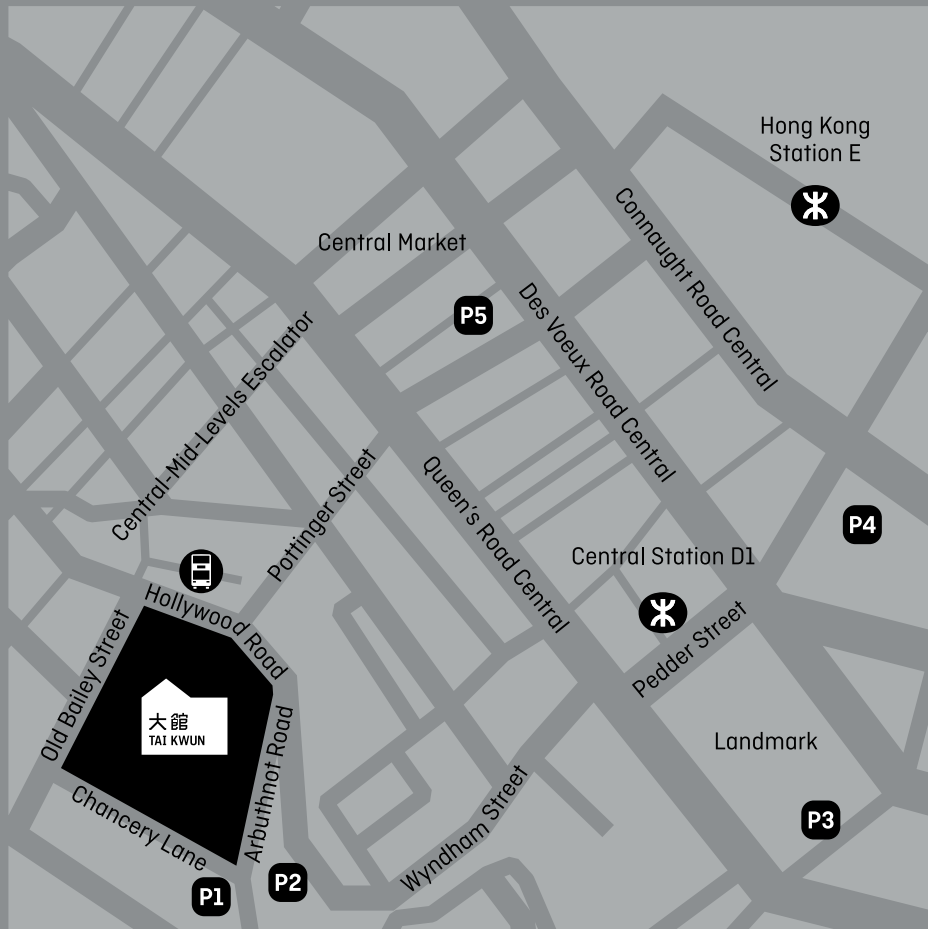

RECOMMENDED TRANSPORTATIONS TO TAI KWUN

✳ MTR

Central Station Exit D1

Walk along Queen's Road Central towards Sheung Wan, turn left at Queen Victoria Street to the former Central Market and take the Central-Mid-Levels Escalators to Tai Kwun

Hong Kong Station Exit E

Exit International Finance Centre (IFC) and walk through the Central Elevated Walkway (footbridge) to Hang Seng Bank Headquarters and the former Central Market, take the Central-Mid-Levels Escalators to Tai Kwun



Bus: Number 12, 12M, 13, 26, 40M, H1 (Stop: Hollywood Road)



Nearby Car Parks

P1 — Universal Trade Centre Car Park, 3 Arbuthnot Rd, Central

P2 — The Centrium Car Park, 2 Arbuthnot Road, Central

P3 — LANDMARK ATRIUM Car Park, Ice House Street, Central

P4 — LANDMARK CHATER Car Park, Connaught Road, Central

P5 — Man Yee Car Park, 60-68, Des Voeux Road, Central

Please check on Tai Kwun Website for more selections of transportations to Tai Kwun.

This document is for information purposes only. The information is provided without warranty of any kind, either express or implied, and is subject to change without prior notice. Approvals from The Jockey Club CPS Limited and/or third parties are required for the use or distribution or exploitation of the contents and/or information herein. Any hiring of event space is subject to the "Terms and Conditions of Hire".

© Tai Kwun 2021 Tai Kwun is the trading name of The Jockey Club CPS Limited

Cover photo credit: Yip Tsz Hin @leaf.works

CONTACT



Please scan the QR Code and fill in the enquiry form, our team will be in touch with you shortly.

www.taikwun.hk